

ALL HANDRAILS & GUARD RAILS TO BE COMPLETE WITH PAINT FINISH - PROVIDE ALTERNATE PRICE TO COMPLETE RAILINGS WITH GALVANIZED FINISH IN LIEU OF PAINT

ALL HANDRAILS & GUARD RAILS SHALL BE DESIGNED & MANUFACTURED IN ACCORDANCE WITH NBC 4.1.5.14. SHOP DRAWINGS SHALL BE COMPLETE UNDER THE SEAL OF A LICENSED STRUCTURAL ENGINEER.

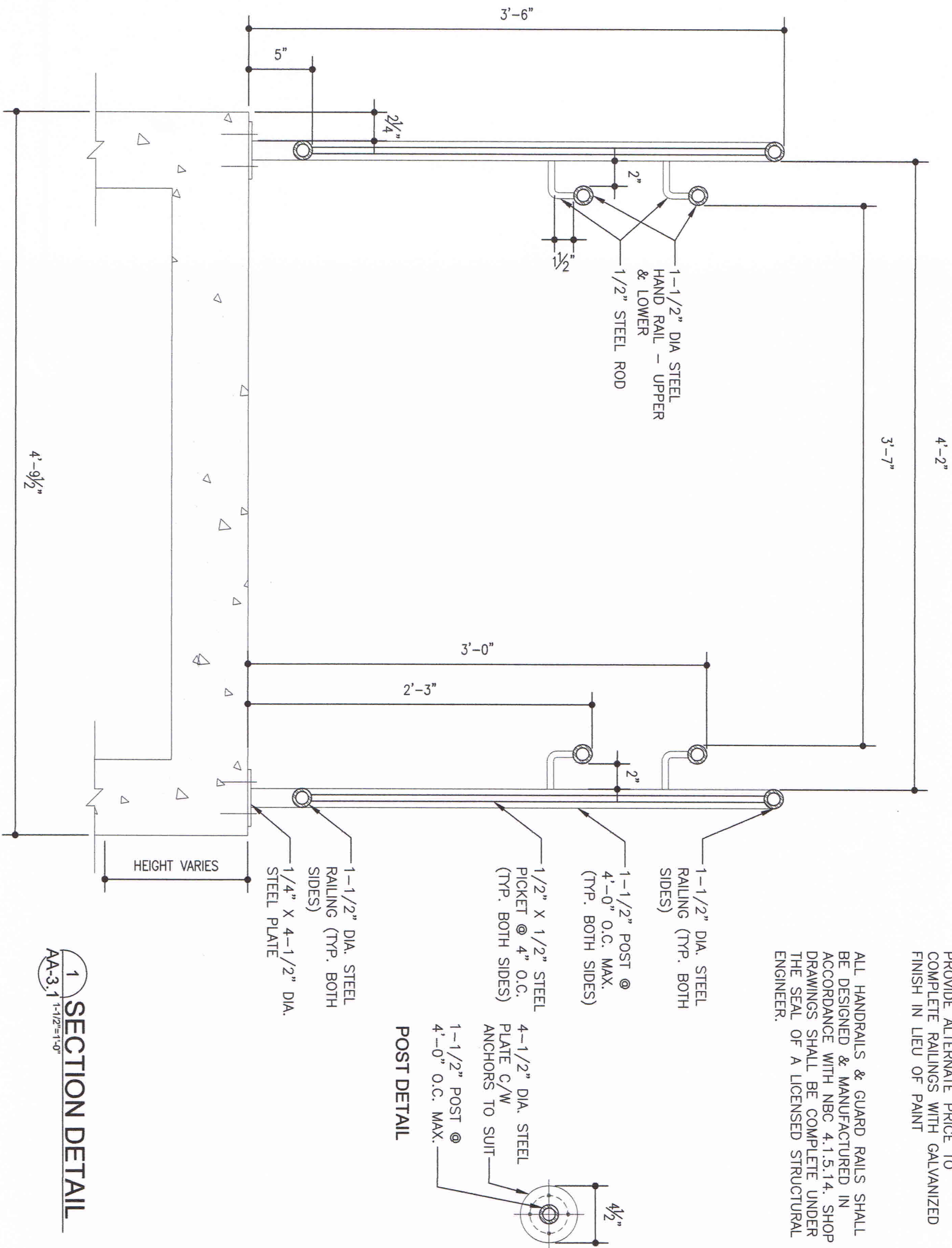

POST DETAIL

1-1/2" POST @
4'-0" O.C. MAX.

4-1/2" DIA. STEEL
PLATE C/W
ANCHORS TO SUIT

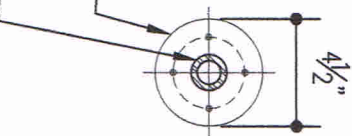

SECTION DETAIL

1
AA-3.1 1-1/2"=1'-0"



John van Leeuwen
Architecture and Design
412-63 Albert Street Wpg. MB R3B 1G4
Ph: 204-504-7443

**SOUTH TRANSCONA COMMUNITY
CENTRE-ACCESSIBLE RAMP
AND STAIR ADDITION**

124 BORDEN AVENUE
WINNIPEG, MANITOBA

CLIENT REVIEW SIGNATURE:

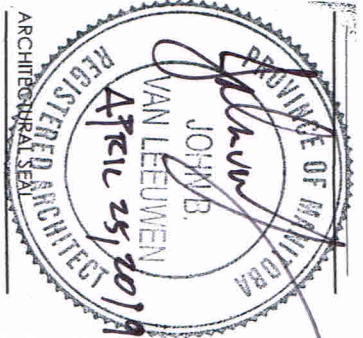

SHEET TITLE:
SECTION DETAIL

PROJECT NO: 2018177

DRAWN BY: RR

CHECKED BY: JV

SCALE: 1-1/2"=1'-0"

ISSUED FOR: CONSTRUCTION

ISSUE DATE: APRIL 16, 2019

AA-3.1

DATE PLOTTED
4/16/19